

Collaborate in AutoCAD anytime, anywhere? Discover the AutoCAD web app!

Kerry Ko

Product Manager, AutoCAD

Scott Price

Sr. Principal User Experience Designer

Access AutoCAD web app
web.autocad.com



Kerry Ko

Product Manager, AutoCAD
Autodesk



Scott Price

Sr. Principal User Experience Designer
Autodesk



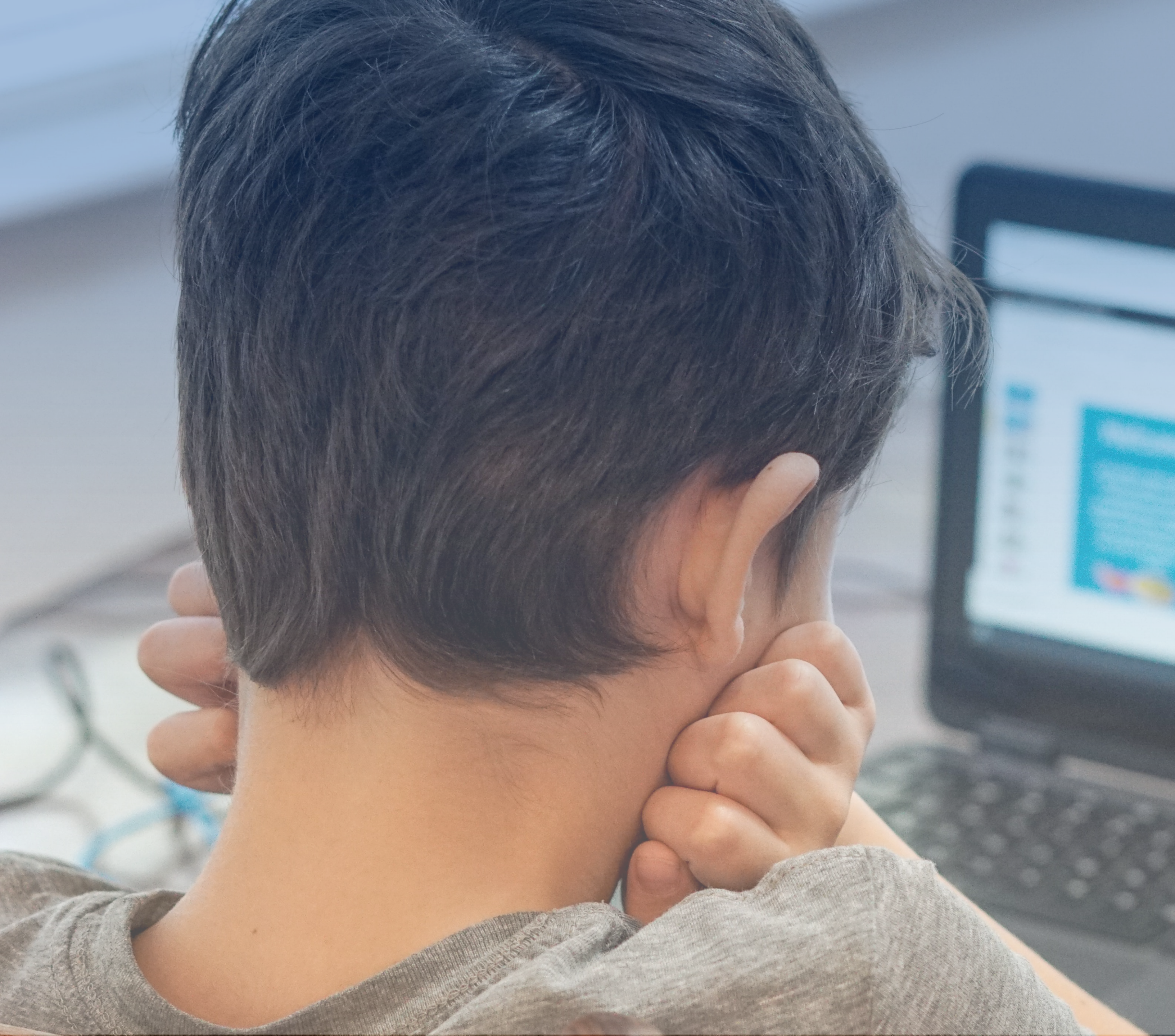





AutoCAD Anywhere



Layers

- Views
- Prop.
- Layers
- Blocks
- XREF

- 0
- A-Anno-Dims
- A-Anno-Iden
- A-Anno-Text
- A-COLS
- A-Door
- A-Elev-Door
- A-Elev-Otln
- A-Elev-Pat
- A-Flor
- A-Flor-Appl

+ New layer

Navigation icons: back, forward, pan, zoom

Open in Desktop Share

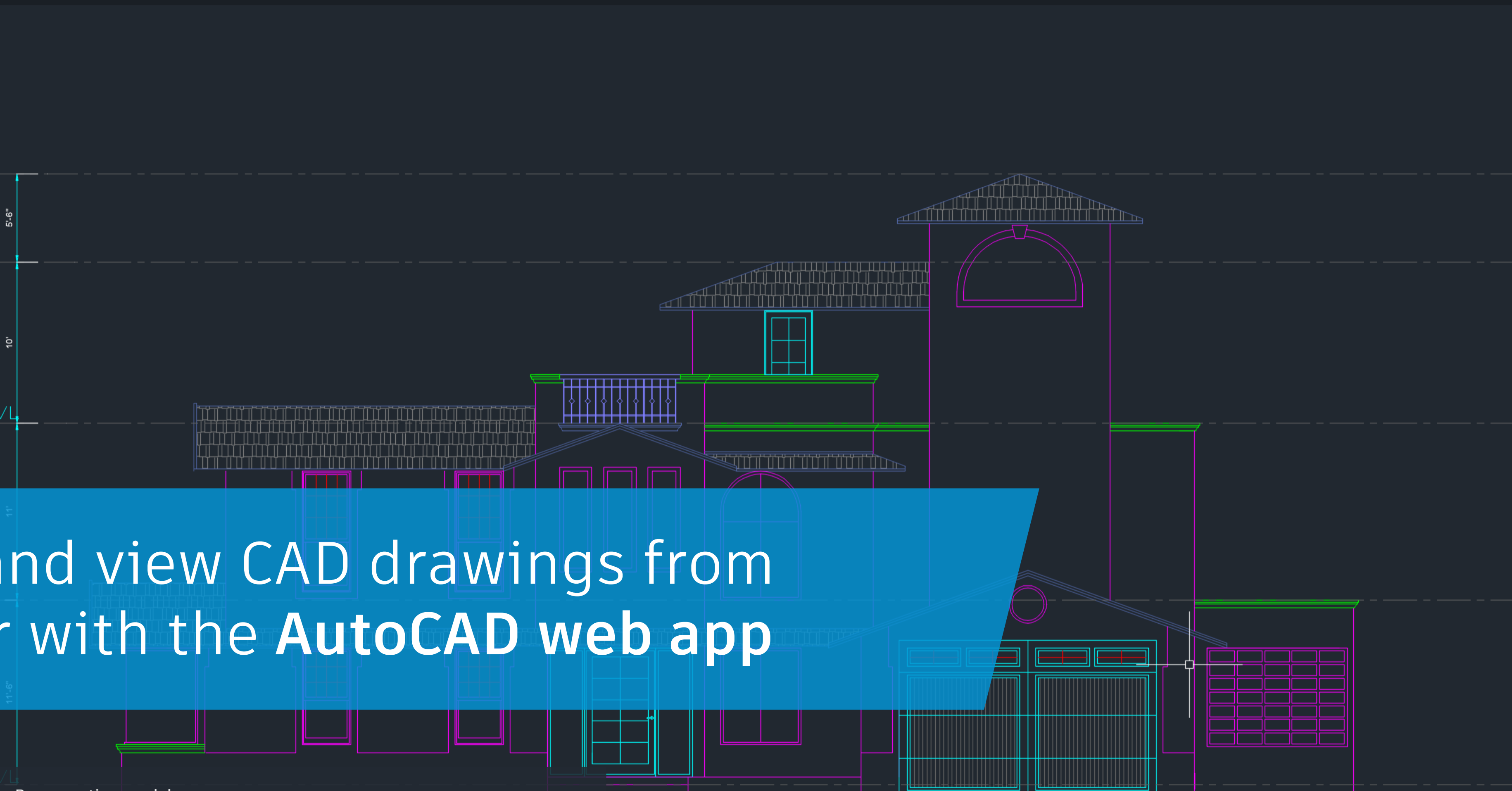

Edit, create, and view CAD drawings from any computer with the **AutoCAD web app**

Draw **Annotate** **Modify**

Icons for drawing tools: rectangle, circle, arc, spline, line, dimension, hatch, table.

Regenerating model.
ZOOM
Specify corner of window, enter a scale factor (nX or nXP), or [All/Center/Dynamic/Extents/Previous/Scale/Window/Object] <real time>:
Specify opposite corner:

> Type a command



If AutoCAD is the toolbox;

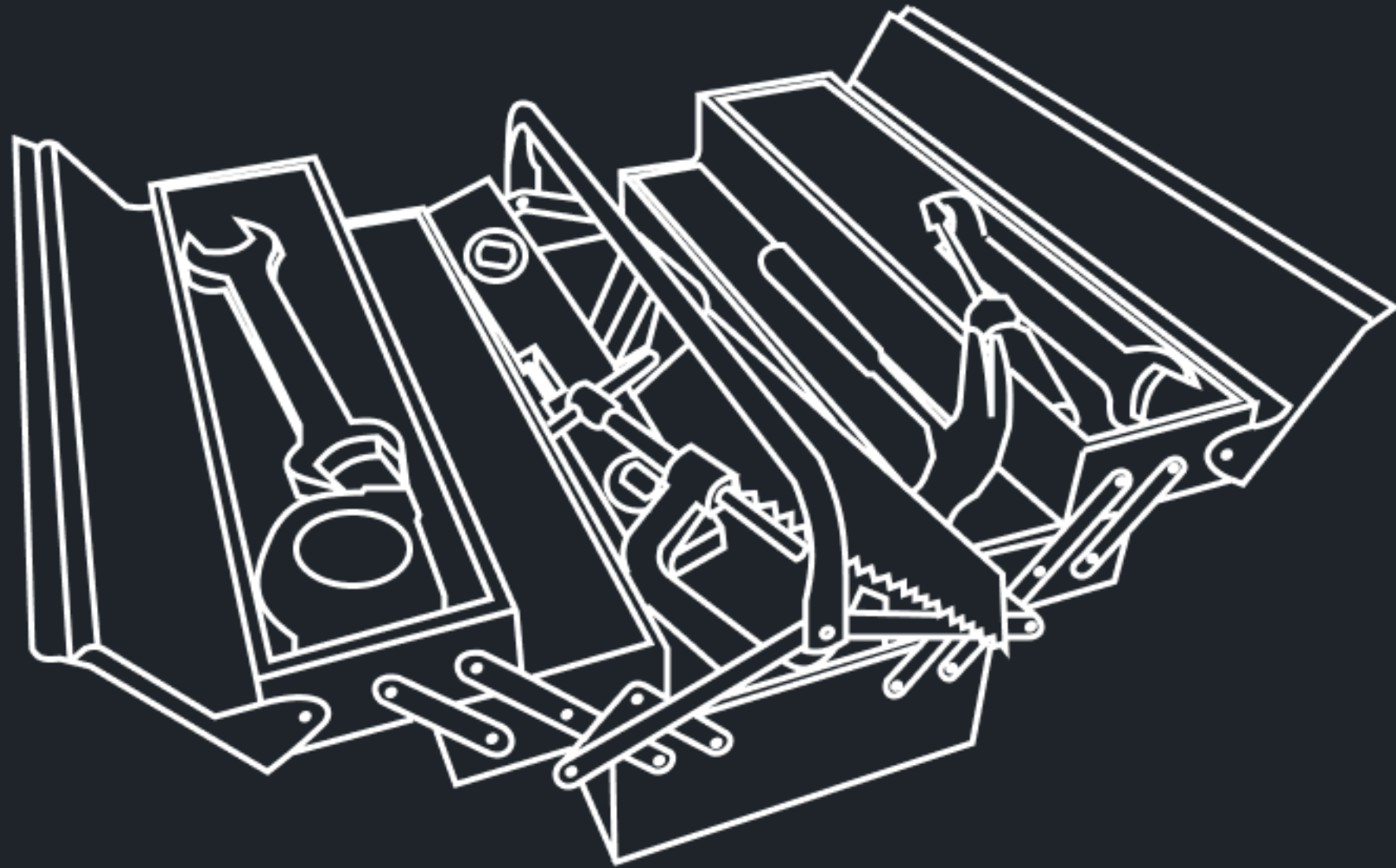

**The AutoCAD web app is
a swiss army knife.**



Chat

Recent

 Kerry K.

 Kerry K.   



 Hi Scott, the client decided to switch the dynamic window shading for the fixed option. Can you update it and send it over to the engineer?

I'm not scheduled to go into the office till Wednesday and don't have CAD on my home laptop – Is Wednesday alright?

 Oh... right – I know the scheduling isn't ideal... you should be able to open in the AutoCAD web app though – just open the file in OneDrive and click "Open in AutoCAD web app"



- My files
- Recent
- Shared
- Recycle bin

[+ New](#)
[↑ Upload](#)
[↗ Share](#)
[🔗 Copy link](#)
[🔄 Sync](#)
[↓ Download](#)
[⚙️ Automate](#)

Sort

My files > 3701 Langford > SD - Floorplans

Name
Building A - Teardown.dwg
Building B - Remod.dwg
Building C.dwg
CUP.dwg

Chat

Recent

 Kerry K.

 Kerry K.   



 Oh... right – I know this scheduling isn't ideal... you should be able to open in the AutoCAD web app though – just open the file in OneDrive and click "Open in AutoCAD web app"

Okay – thanks for the suggestion. I got it open and made a note about the shading.

I don't have access to my blocks though - they are in a folder on my office desktop. Will just the note be ok?

 Andrea set up shared block libraries for us, check the blocks palette and see if you can find it.



Blocks

Current drawing [document icon] [clock icon] [star icon] [list icon]

Views [eye icon]

Prop. [plus icon]

Layers [stack icon]

Blocks [circular arrow icon]

XREF [link icon]

Create block [plus icon]

Border [border icon]

BR 1 [BR 1 icon]

BR 5 [BR 5 icon]

BRISE 1 [BRISE 1 icon]

Door 1 [Door 1 icon]

J1 [J1 icon]

J3 [J3 icon]

P1 [P1 icon]

Browse for blocks...

Block Properties

Block name Border

Reference count 1

Draw [move icon] [copy icon] [paste icon] [undo icon] [redo icon] [erase icon] [trim icon] [extend icon] [fillet icon] [chamfer icon] [stretch icon] [stretch point icon] [stretch opposite corner icon] [stretch point icon]

Annotate [dimension icon] [text icon] [leader icon] [table icon] [table of contents icon] [table of contents icon]

Modify [undo icon] [redo icon] [copy icon] [paste icon] [erase icon] [trim icon] [extend icon] [fillet icon] [chamfer icon] [stretch icon] [stretch point icon] [stretch opposite corner icon] [stretch point icon]

[undo icon] [redo icon] [pan icon] [zoom icon] [share icon]

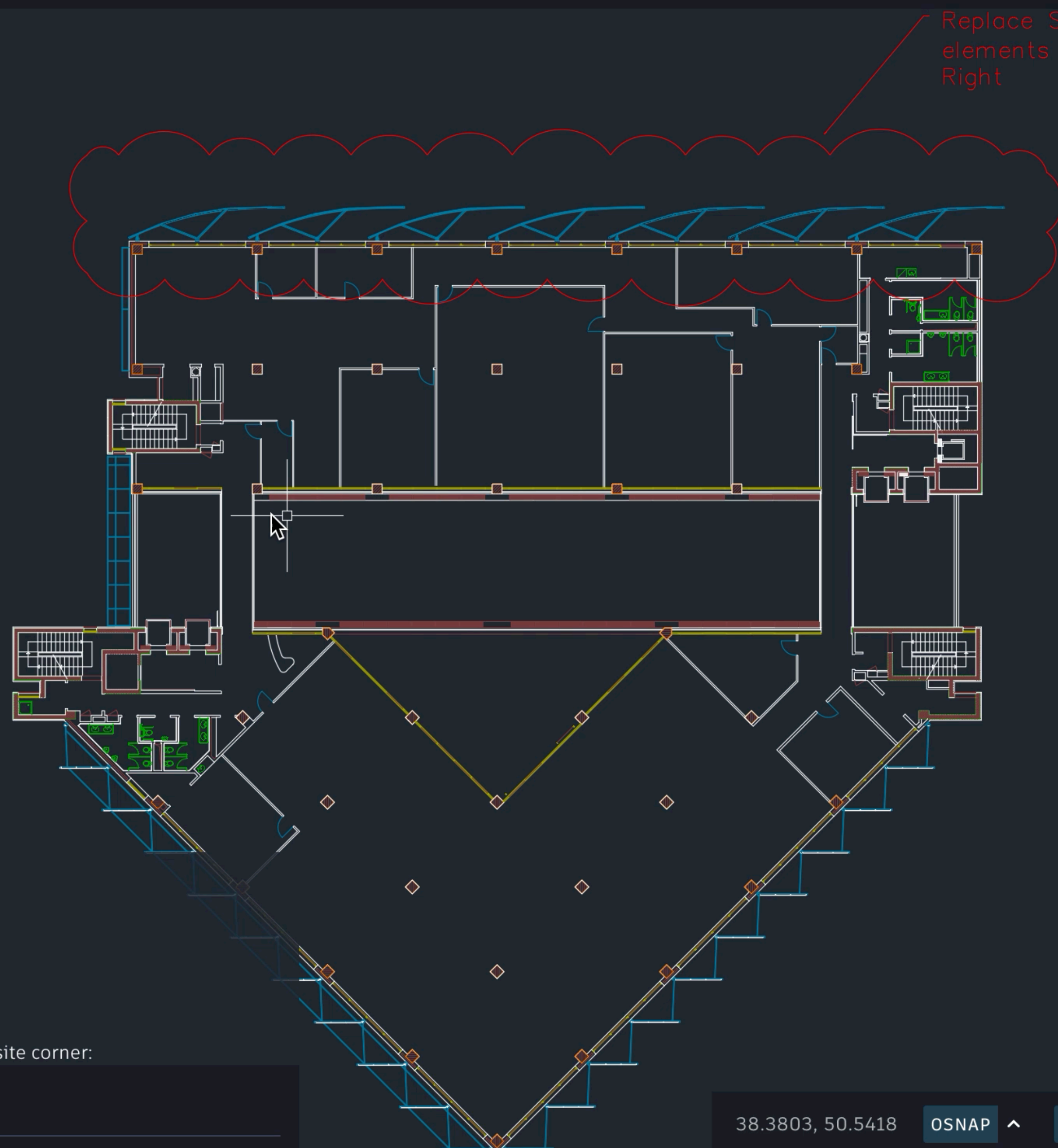

Replace Shading elements w/ Fixed Right

** STRETCH **

Specify stretch point:

** STRETCH **

Specify stretch point:

Command: Specify opposite corner:

> Type a command

Chat

Recent

 Kerry K.

 Kerry K.   



 Andrea set up shared block libraries for us, check the blocks palette and see if you can find it.

Wow – thanks for walking me through it. AutoCAD web app is all new to me, but I was able to get everything done.

Send the DWG to the Engineer?

 Actually, go ahead and plot a PDF and send that

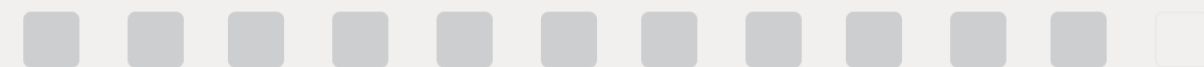

Layers

- Views
- Prop.
- Layers
- Blocks
- XREF

0	<input type="checkbox"/>
1F	<input checked="" type="checkbox"/>
1FIN	<input checked="" type="checkbox"/>
2F	<input type="checkbox"/>
2FIN	<input type="checkbox"/>
Border	<input checked="" type="checkbox"/>
CAI	<input checked="" type="checkbox"/>
CAIX	<input checked="" type="checkbox"/>
Doors	<input checked="" type="checkbox"/>
Equipment	<input checked="" type="checkbox"/>
ESTR	<input checked="" type="checkbox"/>
FAC	<input checked="" type="checkbox"/>

[+ New layer](#)

Layer Properties

Name	Revision
Linetype	Continuous ⌵
Lineweight	Default

Draw Annotate **Modify**

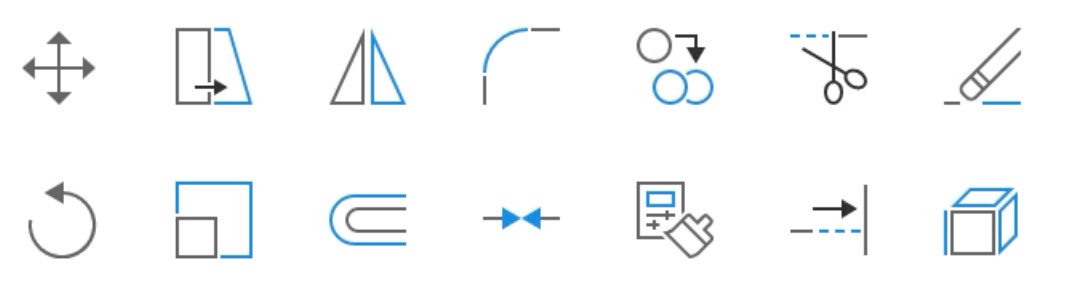

Navigation icons: Back, Forward, Pan, Zoom In, Zoom Out, Share

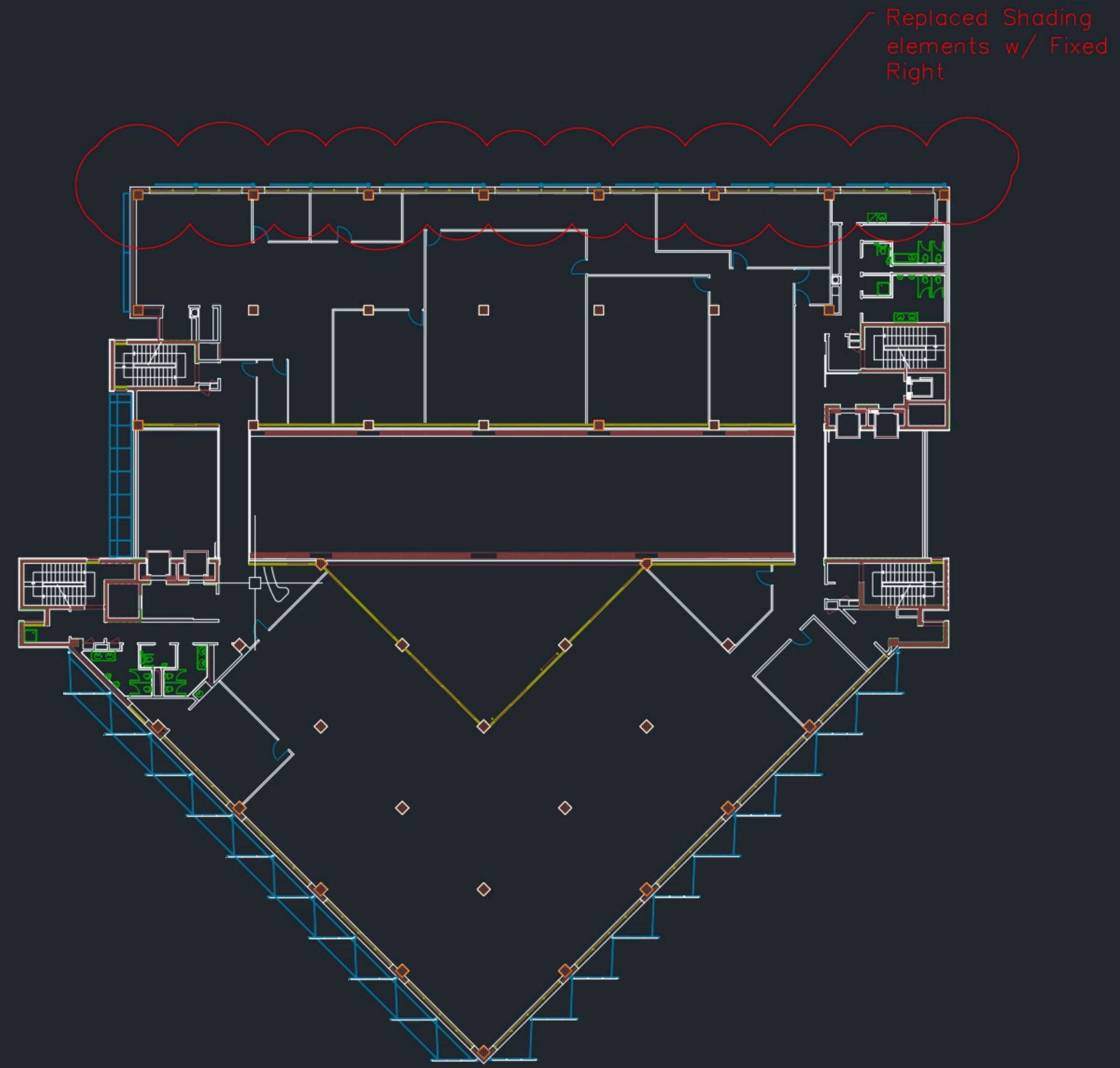

Command: *Cancel*
Command: Specify opposite corner:
Command: *Cancel*
Command: Specify opposite corner:
Command: *Cancel*

> Type a command

Chat

Recent

 Kerry K.

 Kerry K.   



 Andrea set up shared block libraries for us, check the blocks palette and see if you can find it.

Wow – thanks for walking me through it. AutoCAD web app is all new to me, but I was able to get everything done.

Send the DWG to the Engineer?

 Actually, go ahead and plot a PDF and send that





Layers

- Views
- Prop.
- Layers
- Blocks
- XREF

0	[white square]
A-Anno-Dims	[white square]
A-Anno-Iden	[green square]
A-Anno-Text	[cyan square]
A-COLS	[blue square]
A-Door	[cyan square]
A-Elev-Door	[cyan square]
A-Elev-Otln	[magenta square]
A-Elev-Pat	[grey square]
A-Flor	[red square]
A-Flor-Appl	[cyan square]

+ New layer

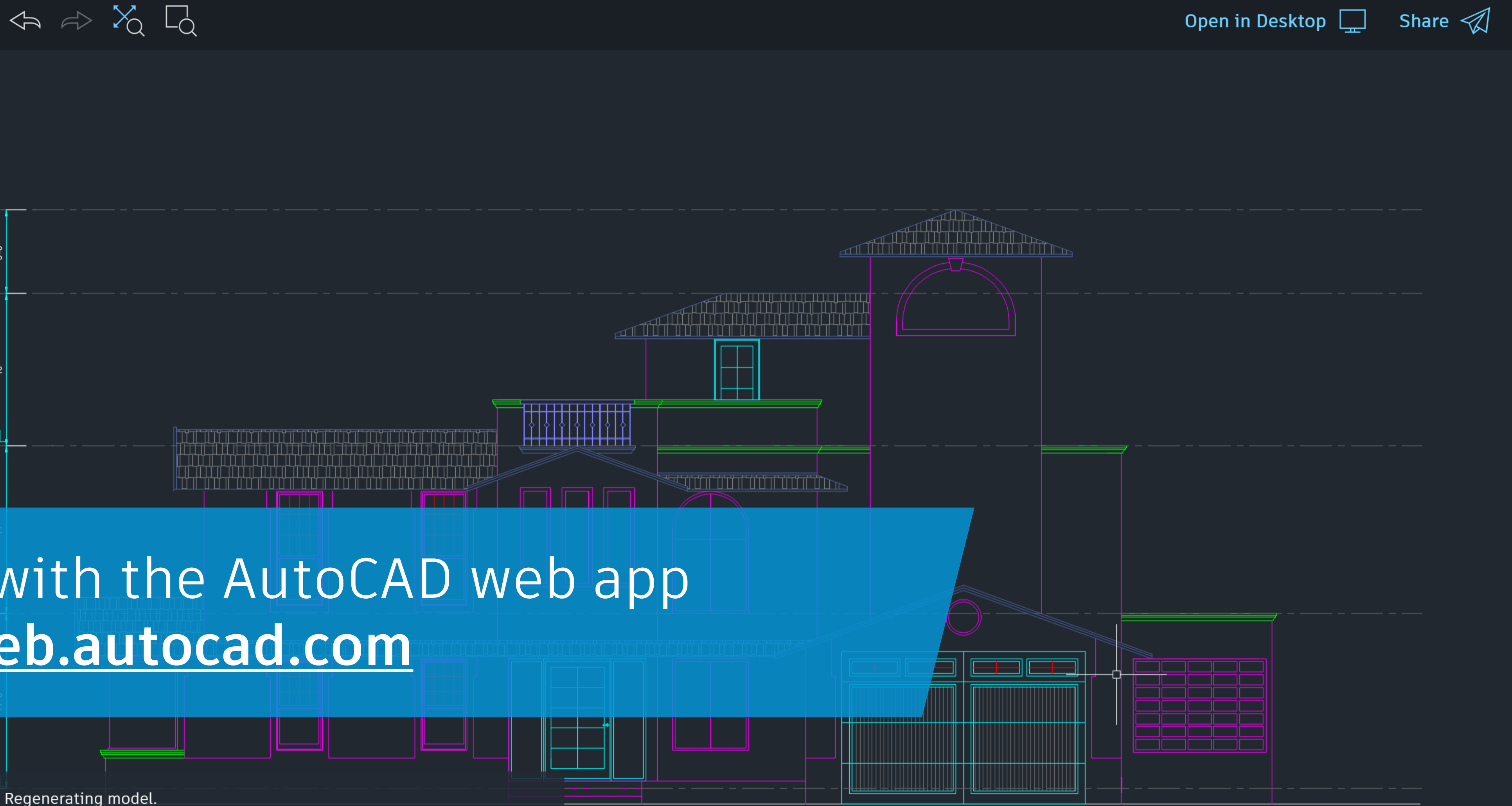

Collaborate with the AutoCAD web app
web.autocad.com

Draw **Annotate** **Modify**

[rectangle icon] [circle icon] [arc icon] [spline icon] [line icon] [dimension icon]

[hatch icon] [table icon]

Regenerating model.
 ZOOM
 Specify corner of window, enter a scale factor (nX or nXP), or
 [All/Center/Dynamic/Extents/Previous/Scale/Window/Object] <real time>:
 Specify opposite corner:

> Type a command



Open with
AutoCAD





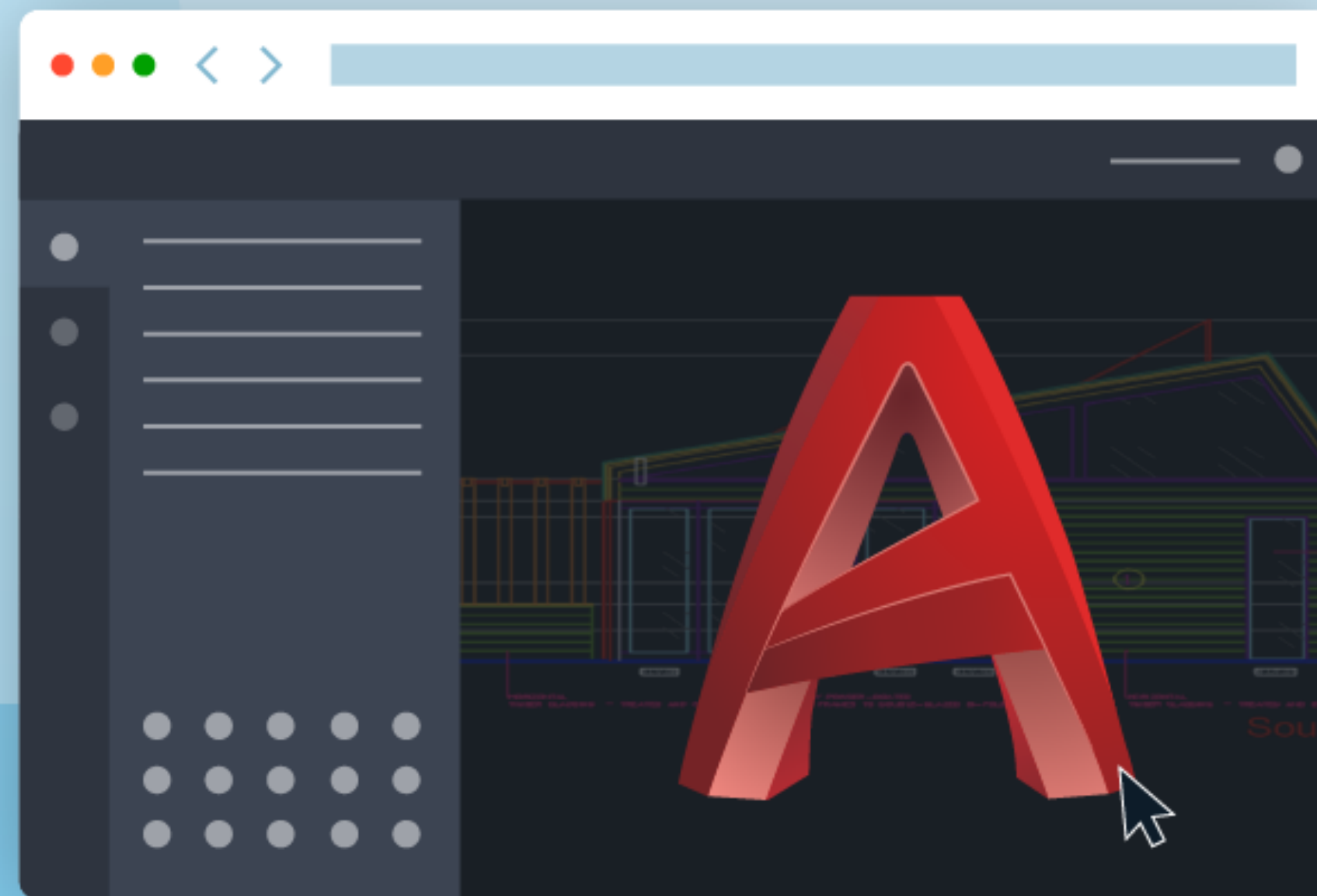

box

Dropbox



Connect to Autodesk Docs

Add storage provider

	Autodesk Docs	Add
	Box	Add
	Dropbox	Add
	Google Drive	Add
	OneDrive	Add

Views

Prop.

Layers

Blocks

XREF

Blocks

Recent blocks [refresh]



Double Sin...



Accessible ...

Q Browse for blocks...

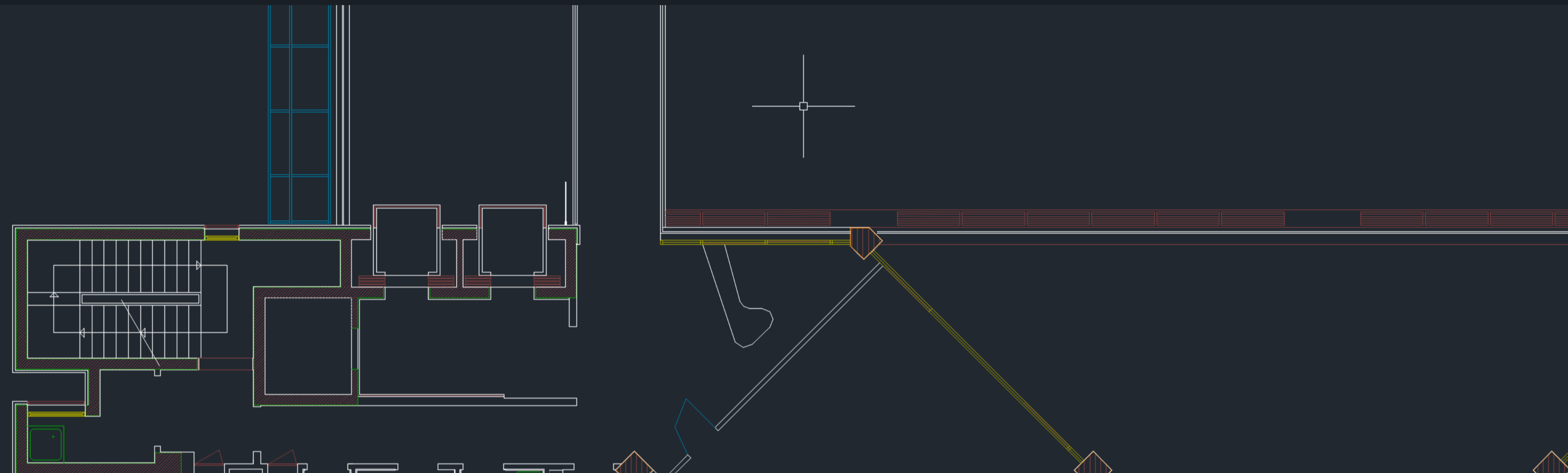

Access your blocks anywhere with recent blocks, favorite blocks, and block libraries

Draw Annotate Modify

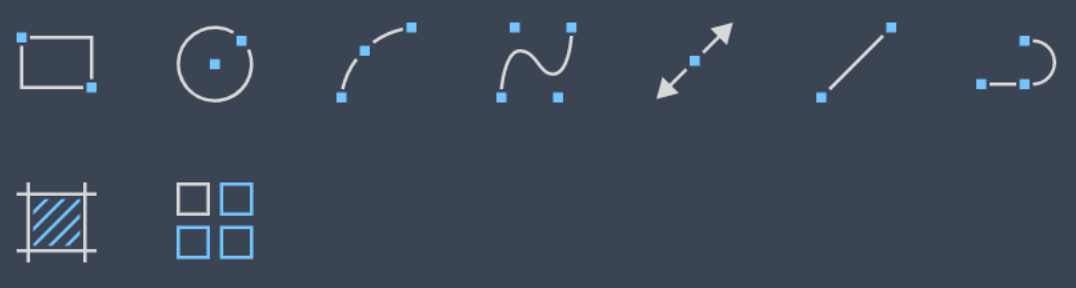

Command: Specify opposite corner:
Command: ZOOM
Specify corner of window, enter a scale factor (nX or nXP), or [All/Center/Dynamic/Extents/Previous/Scale/Window/Object] <real time>:
Specify opposite corner:

> Type a command

Views

External References

OFFICE SPACE... PARKING.dwg

SITE PLAN.dwg

+ Attach XREF

Prop.

XREF Properties

Reference name OFFICE SP...D PARKING

Status Resolved

Size 137 KB

Type Attach

Date Oct 24, 2019, 1:01 PM

Found at /01_Proje...RKING.dwg

Layers

Blocks

XREF

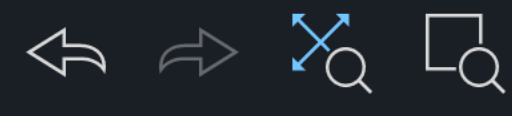

Open in Desktop [computer icon] Share [share icon]

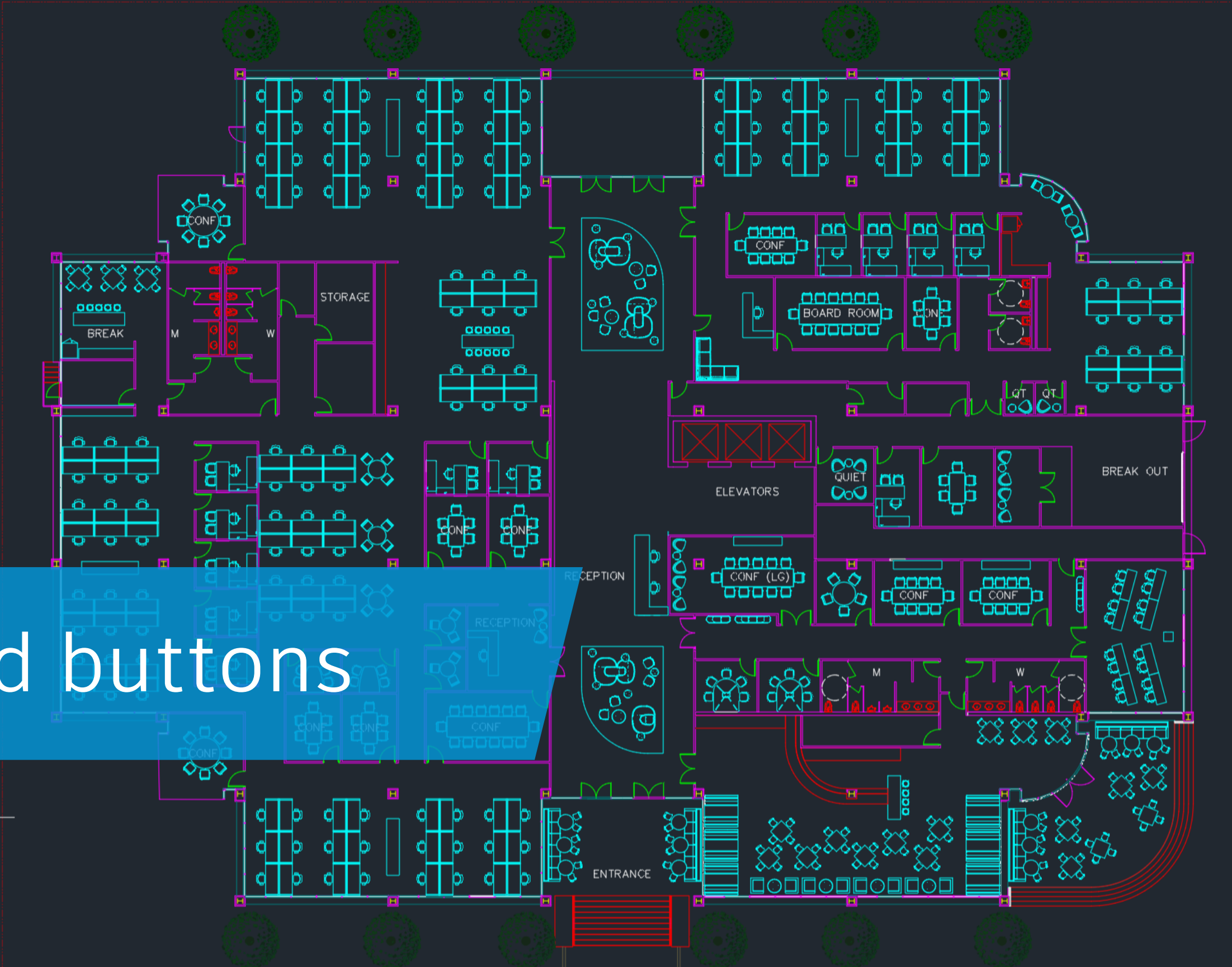

Edit with command line and buttons

- M (MOVE)
- MA (MATCHPROP)
- MEA (MEASUREGEOM)
- MI (MIRROR)
- MLD (MLEADER)
- MO (PROPERTIES)
- MREDO

Draw Annotate Modify



> m

Esc

394'-9 1/2", -34'-4 3/8" OSNAP OTRACK ORTHO POLAR

Create PDF output with **plot**

Plot to PDF [Close]

What to print	Display
Scale	Scale to Fit
Plot style	monochrome.stb
Paper size	Letter (8.50 x 11.00 Inches)

Orientation

Portrait

Landscape



Cancel Plot to PDF

AutoCAD web app

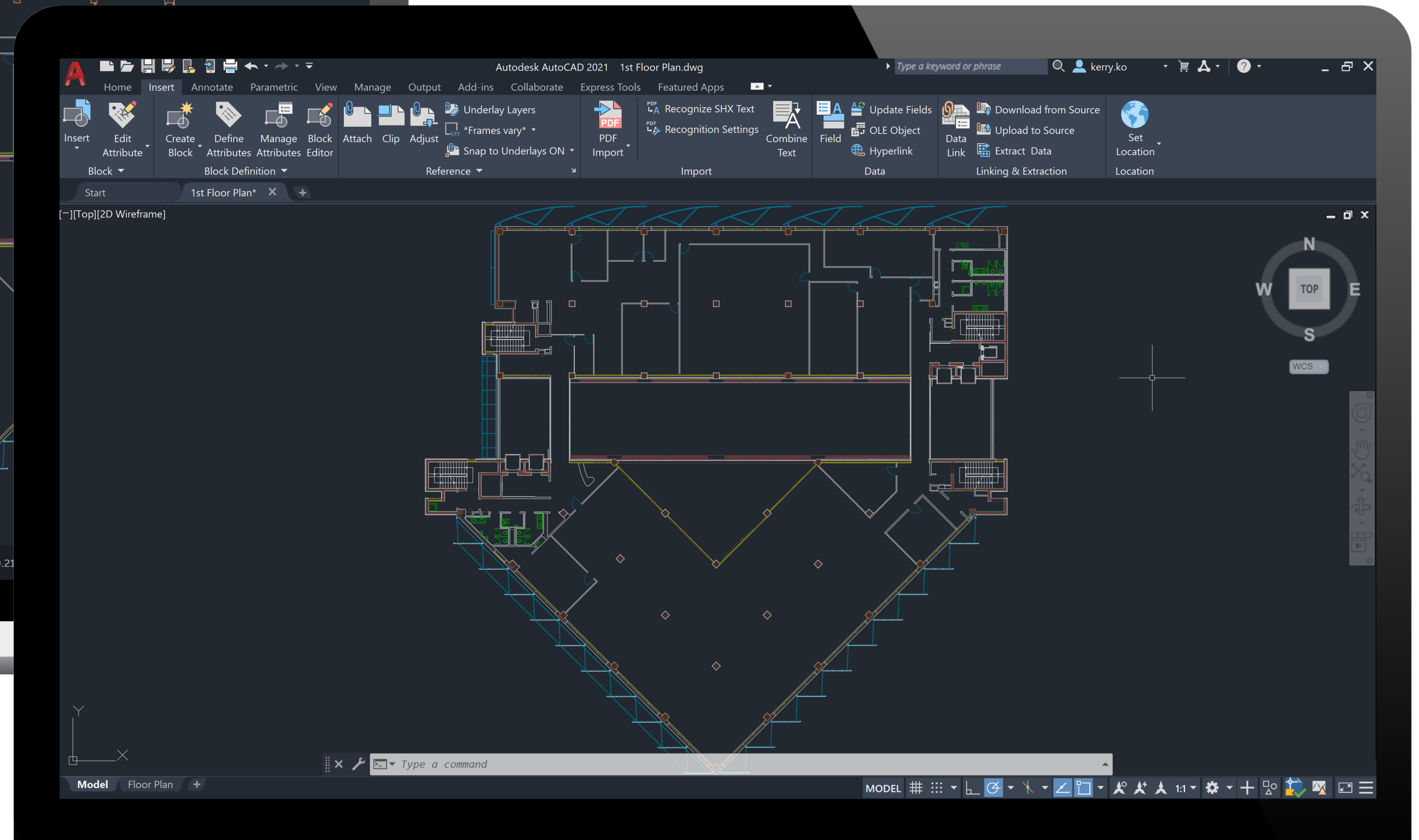
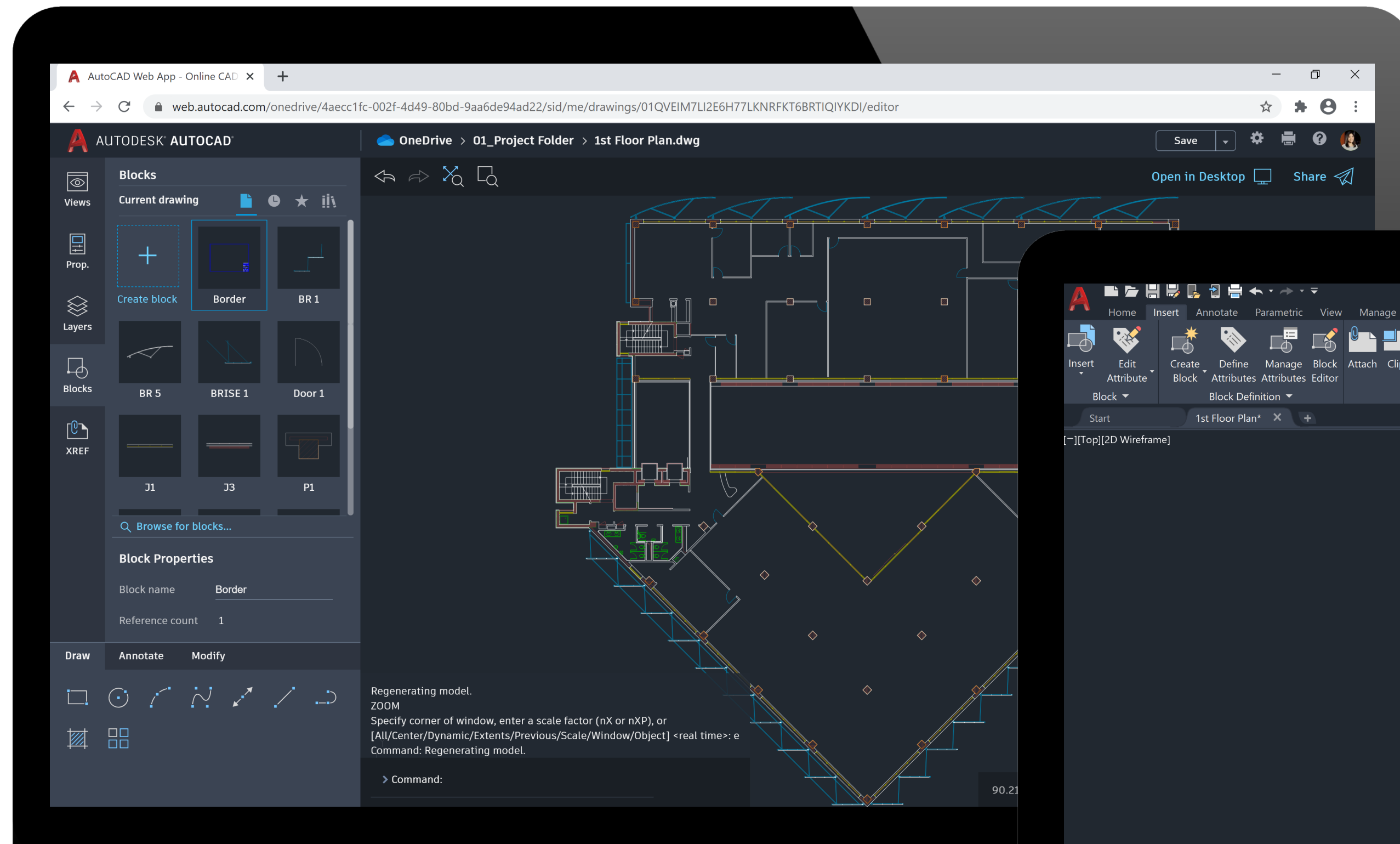

Open in Desktop

AutoCAD on desktop

AutoCAD. Anywhere.

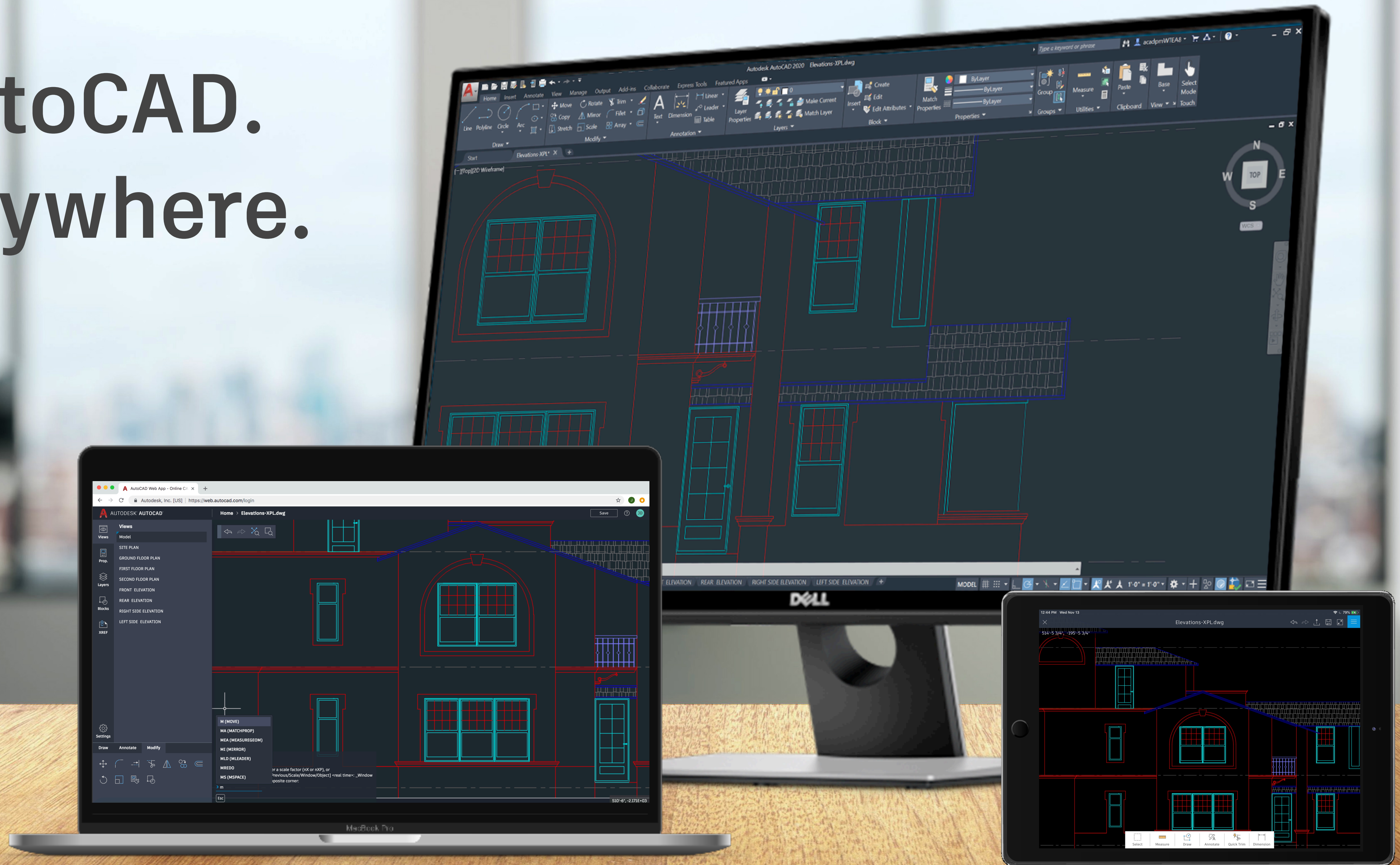



Share your story
autode.sk/autocadstory

Layers

- Views
- Prop.
- Layers

- 0
- A-Anno-Dims
- A-Anno-Iden
- A-Anno-Text
- A-COLS
- A-Door
- A-Elev-Door
- A-Elev-OtIn
- A-Elev-Pat
- A-Flor
- A-Flor-Appl
- + New layer

Blocks

- XREF

Layer Properties

Name	A-Furn
Linetype	Continuous ▾
Lineweight	0.00mm

Layer Properties

Name	A-Furn
Linetype	Continuous ▾
Lineweight	0.00mm

Draw Annotate Modify

📐 ⚙️ 🔍 📏

↩️ ↪️ 🔍 📏

Access AutoCAD web app

web.autocad.com

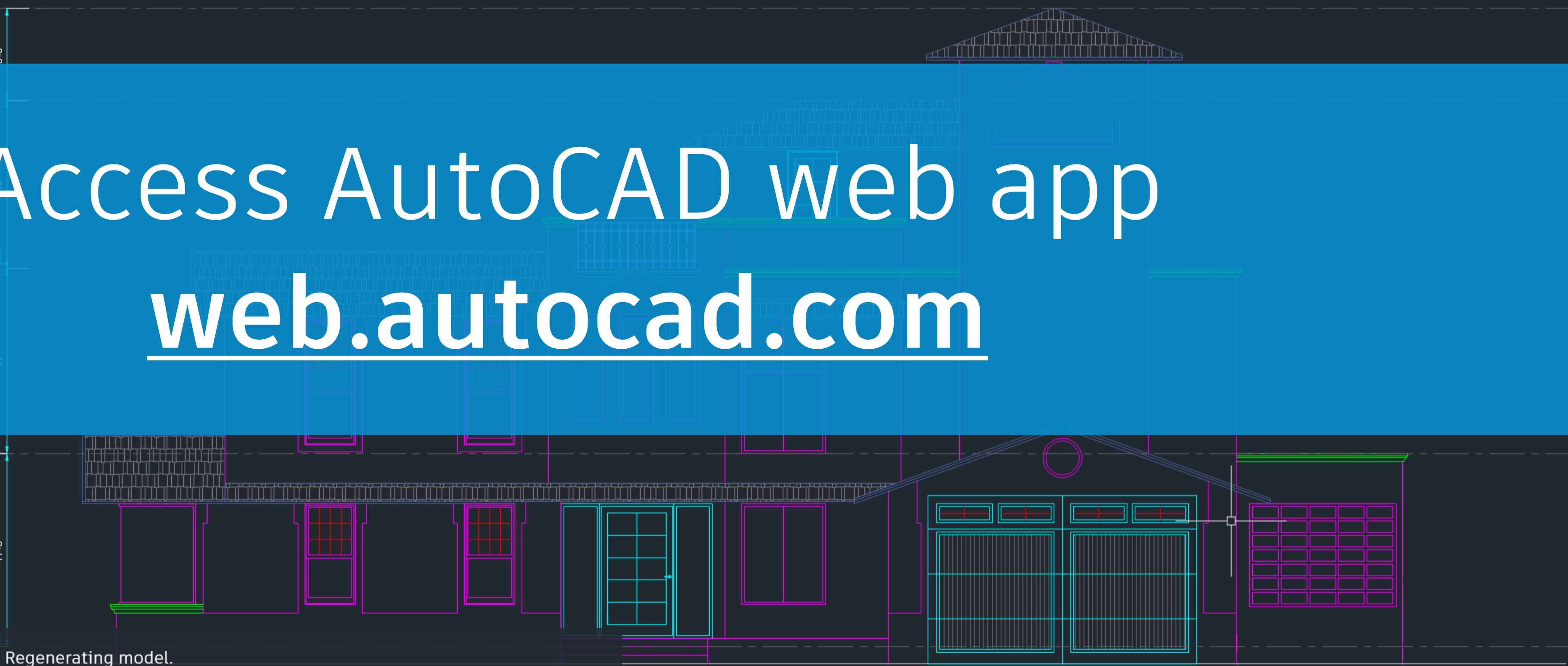

Regenerating model.
 ZOOM
 Specify corner of window, enter a scale factor (nX or nXP), or
 [All/Center/Dynamic/Extents/Previous/Scale/Window/Object] <real time>:
 Specify opposite corner:

> Type a command

ION



Access AutoCAD web app
web.autocad.com

Autodesk and the Autodesk logo are registered trademarks or trademarks of Autodesk, Inc., and/or its subsidiaries and/or affiliates in the USA and/or other countries. All other brand names, product names, or trademarks belong to their respective holders. Autodesk reserves the right to alter product and services offerings, and specifications and pricing at any time without notice, and is not responsible for typographical or graphical errors that may appear in this document.

© 2020 Autodesk. All rights reserved.

